

DID YOU KNOW?



about our... **Class 8.8 - Chemical Anchor Stud**

Hobson Chemical Anchor Studs are supplied with a nut and washer and are used as masonry anchors when combined with a suitable chemical injection system. The embedment mark allows for easy identification of embedment depth after installation.

CHEMICAL ANCHOR STUD - CHISEL POINT HOT DIP GALVANISED / CLASS 8.8 / HEC



Part	Qfind	Size	Length (mm)	Embedment Notch (mm)	Pack Qty
MCA88GCM120160H	MCA120	M12	160	110	10
MCA88GCM160190H	MCA121	M16	190	125	10
MCA88GCM200260H	MCA122	M20	260	170	10
MCA88GCM240300H	MCA123	M24	300	210	5



Applications

- Fixing to concrete or masonry substrates
- Holding down machinery
- Commonly used in applications that require non expansion type fasteners
- Used in applications that require closer edge distance and spacing



External Hex Drive



Embedment Notch



1/4 External Drive Bit Included

An external hex drive bit included in each pack of external hex drive stud anchors.

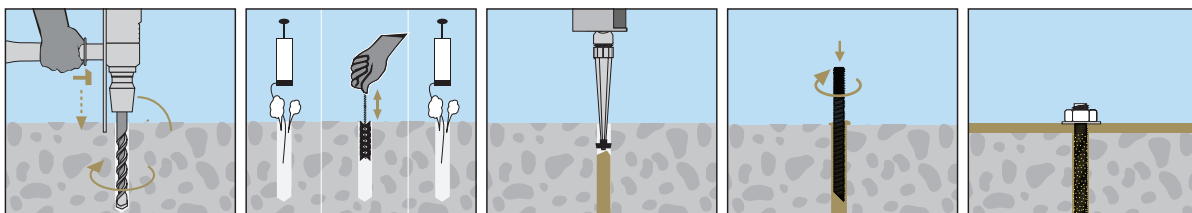

CONX[®]TRUCT

Bolt Tension | Anti-Vibration | Product Reliability | Traceability

hobson.com.au **QUALITY FASTENERS SINCE 1935**

